



SAPPORO-DAKE

札幌岳 Ski Tour Map 1:25000



0 250 500 750 1000m

1cm on the map equals approx. 250m on the ground
Magnetic declination: 9° 28' W

Map by hokkadowilds.org CC BY-SA 4.0

Symbol Key (some may not be present)

	Route (time between points)		Contour lines (100m, 10m)
	National Highway		Power transmission lines
	Prefectural Road		Trees/no tree
	Municipal Road		Rocks/cliff
	Minor Municipal Road		Onsen (hot spring)
	Walkway		Fumerole
	Bus route (bus stop)		Highway number
	Avalanche-prone slope		Designated campsite
			Hut

この地図の作成に当たっては、国土院院長の承認を得て、同院発行の基盤地図情報及び電子地形図（タイル）を使用した。（承認番号 平 30 情使、第 867 号）。また、1/25,000 標高図 GIS データ（環境省生物多様性センター）も使用し、hokkadowilds.org が作成・加工したものである。
This map uses the Geospatial Information Authority of Japan digital basemap (tiles) and basemap data, with the permission of the Authority's director (permission no. 平 30 情使、第 867 号). It also uses modified 1:25,000 scale vegetation map GIS data created by the Biodiversity Center of Japan, Ministry of the Environment (<http://gis.biodic.go.jp>).

Japanese Map Glossary

Romaji	Kanji	English
bunki	分岐	junction
cho	町	town
dake/mine	岳/峯	peak
eki	駅	station
goya/koya	小屋	hut
hinangoya	避難小屋	shelter
ike	池	pond
kawa/gawa	川	river
kako	火口	crater
ko/mizumi	湖	lake
kyo	峡	gorge
numa	沼	pond
onsen	温泉	hot spring
sawa	沢	stream
taira/daira	平	plateau
tani/dani	谷	valley
taki	滝	waterfall
toge	峠	pass
yama/san/zan	山	mountain



Sapporo-dake Ski Touring



5.5hrs
Time



851m
Total Climb



1293m
Highest point



12km
Distance



6/10
Difficulty



Jan-Apr
Best season

Mt. Sapporo (札幌岳, 1,293m) is a popular peak in the Jozankei area, not least of all for its name - the same as the city in which it stands. Half way up the route to the peak is the Hokkai Gakuen University managed Hi Yamizu Hut (冷水小屋, 845m), available for overnight stays on the first and third weekends of the month. From the hut, there are a multitude of great slopes to choose from for magnificent skiing. Steep, mellow, and everything in between. Mt. Sapporo's summit offers expansive views over Sapporo City and surrounds. Enjoy as a day-trip or very comfortable overnigher.

LOCATION

This route starts at the upper end of Jozankei village in the western reaches of Sapporo City, on the road towards Jozan Lake.

GENERAL NOTES

This is one of those compact-topogra-

phy narrow-valley-approach routes quite typical of the Jozankei area and hills west of Sapporo City. This allows for A) a very sheltered route to the hut, and B) some great varied terrain higher up beyond the hut. Be prepared for a very short section of boot-packing (or a scramble on skis) just behind the hut at the head of the gully. Beyond that it is gloriously open.

ROUTE MARKERS

The route to the hut follows the summer trail, which is marked sporadically with tape tied to trees. From the hut, the winter route diverges and is not marked.

ROUTE TIMING

About 2 hours from carpark to hut, up to another two hours from hut to summit. From summit back to the carpark is just over 1 hour.

TRANSPORT

By car: There is ample road-side parking at the trailhead.

Public transport: There is no public transport to the trailhead. The closest you'll get to the trailhead by public transport is Hoheikyo Onsen (豊平峡温泉) bus stop. From there to the trailhead is a 2.3km walk (route here).

SAFETY NOTES

The main common risks noted in guidebooks are avalanche risk on the western slopes behind the hut and route-finding difficulties in low visibility on the open plateau leading to the summit.

ONSEN NEARBY

The gorgeous Hoheikyo Onsen (豊平峡温泉) has one of the largest outdoor bathing areas of any onsen in Hokkaido. It is worth a visit if you've never been before (1,000yen per person), just down the road from the trailhead. They also have a food court with Indian curry and Japanese soba noodles. ■



ONLINE ROUTE GUIDE

Please visit the full route guide for GPS file, interactive map, and extra safety notes: <http://bit.ly/sapp-dake>



Disclaimer The information on this map was derived from digital databases provided by the Geospatial Information Authority of Japan and the Biodiversity Center of Japan. Care was taken in the creation of this map. HokkaidoWilds.org cannot accept any responsibility for errors, omissions, or positional accuracy. There are no warranties, expressed or implied, including the warranty of merchantability or fitness for a particular purpose, accompanying this product. However, notification of any errors will be appreciated.

MAP, TEXT, PHOTOS | Rob Thomson

hokkaidowilds.org 2019/01/30

MAP FOLD & LAYOUT CONCEPT | Dominiika Gan

Unless indicated otherwise, all content on this PDF (pages 1 to 2) is licensed under a Creative Commons Attribution-ShareAlike 4.0 International License (CC BY-SA 4.0). Please attribute <author-name> (hokkaidowilds.org), and let us know so we can link to your work. E.g., "Photo by Rick Siddle (hokkaidowilds.org)"



HIYAMIZU HUT



Details: Two-story well kept hut, available on the first and third weekends of the month, from 1st Jan till 31st Oct. Officially not available for use outside these times.

Capacity: 30 persons.

Cost: 350yen per night.

Management & Contact: Hokkai Gakuen University (TEL: 011-841-1161).

Booking details: Stays must be booked at least 3 working days in advance.

PRINTING INSTRUCTIONS

STEP 1

Load your printer with A4 printer paper (210mm x 297mm). If you've only got Letter size (215.9mm x 279.4 mm), just follow the instructions below. You'll achieve an accurate scale, but the map will be clipped a little at the top and bottom.

STEP 2

Open the print window by clicking on File > Print (or hitting **Ctrl + P** on your keyboard).

STEP 3

Make sure "Actual Size" is selected.

STEP 4

For double-sided printing, select "Print on both sides of paper".

STEP 5

For best results, select the highest quality print option available on your printer (settings will vary).

STEP 6

You won't need this instructions page, so just select pages 1-2.

STEP 7

Click "Print".

PLEASE PRINT AT 'ACTUAL SIZE' (NO SCALING)

The 1:25,000 scale used in the map is accurate if the PDF is printed without scaling (i.e., ACTUAL SIZE). Follow the instructions on this page to ensure an accurate rendering of the scale.

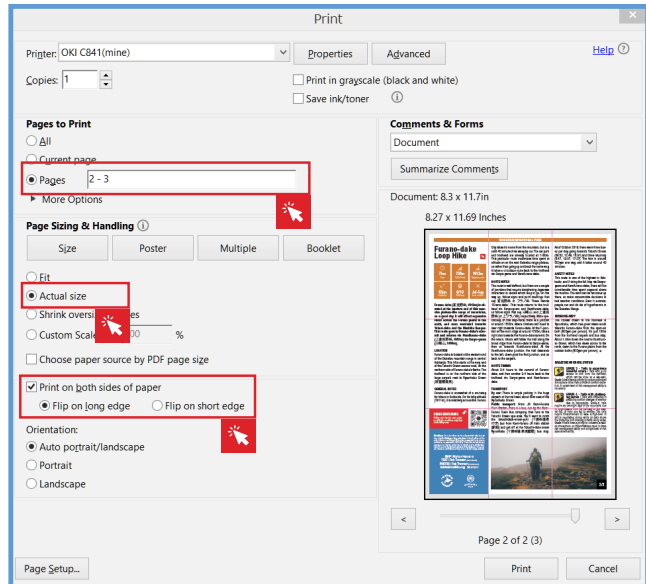

Figure 1. Ensure "Actual Size", and Pages 1-2 are selected (Windows).

ORIGAMI (FOLDING) INSTRUCTIONS

